



Longford Primary Academy

Academic year 2020-2021

Hand in Hand we Learn

We are confident, creative & caring

Important dates:

INSET DAYS

01/09/2020

23/10/2020

04/01/2020

12/02/2020

28/05/2020

School Terms and Holiday Dates 2020/2021

	SEPTEMBER				OCTOBER				NOVEMBER					
Mon	7	14	21	28	5	12	19	26	2	9	16	23	30	
Tues	1	8	15	22	29	6	13	20	27	3	10	17	24	
Wed	2	9	16	23	30	7	14	21	28	4	11	18	25	
Thurs	3	10	17	24		1	8	15	22	5	12	19	26	
Fri	4	11	18	25		2	9	16	23	6	13	20	27	
Sat	5	12	19	26		3	10	17	24	7	14	21	28	
Sun	6	13	20	27		4	11	18	25	1	8	15	22	29

	DECEMBER				JANUARY				FEBRUARY				
Mon	7	14	21	28	4	11	18	25	1	8	15	22	
Tues	1	8	15	22	29	5	12	19	26	2	9	16	23
Wed	2	9	16	23	30	6	13	20	27	3	10	17	24
Thurs	3	10	17	24	31	7	14	21	28	4	11	18	25
Fri	4	11	18	25		1	8	15	22	5	12	19	26
Sat	5	12	19	26		2	9	16	23	6	13	20	27
Sun	6	13	20	27		3	10	17	24	7	14	21	28

	MARCH				APRIL				MAY					
Mon	1	8	15	22	29	5	12	19	26	3	10	17	24	31
Tues	2	9	16	23	30	6	13	20	27	4	11	18	25	
Wed	3	10	17	24	31	7	14	21	28	5	12	19	26	
Thurs	4	11	18	25		1	8	15	22	6	13	20	27	
Fri	5	12	19	26		2	9	16	23	7	14	21	28	
Sat	6	13	20	27		3	10	17	24	1	8	15	22	29
Sun	7	14	21	28		4	11	18	25	2	9	16	23	30

	JUNE				JULY				AUGUST					
Mon	7	14	21	28	5	12	19	26	2	9	16	23	30	
Tues	1	8	15	22	29	6	13	20	27	3	10	17	24	31
Wed	2	9	16	23	30	7	14	21	28	4	11	18	25	
Thurs	3	10	17	24		1	8	15	22	5	12	19	26	
Fri	4	11	18	25		2	9	16	23	6	13	20	27	
Sat	5	12	19	26		3	10	17	24	7	14	21	28	
Sun	6	13	20	27		4	11	18	25	1	8	15	22	29

Autumn Term

* 1st Half Term 39 days

2nd Half Term 35 days

Spring Term

1st Half Term 30 days

2nd Half Term 35 days

Summer Term

1st Half Term 19 days

2nd Half Term 36 days

* includes one in service training day

 In-service training day

 May Bank Holiday

 School Holidays

 Weekends

September

- ▶ Plans made assume a full return to school in September, however we are awaiting further Government guidance to enable us to establish exactly what the school day and provision will look like.
- ▶ As soon as guidance is received further planning will take place and communicated with all parents
- ▶ It is our intention to continue with an **early Friday** (to all pupils) close to allow us to deep clean all rooms and disinfect with Viro-kill fogging machine.
- ▶ Before and after school provision (Wings) is under constant review in line with Government guidance. Updates will be provided.

Senior Leadership Team

Ms Chambers	Principal
Mrs Lawrence	Vice Principal
Mrs Brooks* (Mrs Lucas - maternity leave)	SENDCO
Mrs Wareham	EYFS lead

Year groups and class teachers: Early Years

Year group	Class Teachers	Teaching Assistants
Nursery	Mrs Hulme	
Reception	Mrs Wareham	Mrs Adams

Year groups and class teachers: Key Stage 1

Year group	Class Teachers	Teaching Assistants
Year 1	Miss Kendall	Mrs Ranford
Year 2	Mrs Gittus & Mrs Brooks	Miss Clarke
Year 2	Mrs Byron* (Mrs Roberts - maternity leave)	Mrs Platt

Year groups and class teachers: Lower Key Stage 2

Year group	Class Teachers	Teaching Assistants
Year 3/4	Mrs Bedworth	Mrs Perry Miss Ellison
Year 3/4	Mrs Mcleod	
Year 3/4	Mrs Bowker	

Year groups and class teachers: Upper Key Stage 2

Year group	Class Teachers	Teaching Assistants
Year 5	Miss Addison	
Year 5	Mrs Ralphs	
Year 6	Miss Chesters	Mrs Corbett

Mrs Davis	Office Administrator
Mrs Mahon	Administrative Assistant
Mrs Machin	Attendance officer & Family Support Officer
Mr Deakin	Premises Officer

EYFS & KS1 classrooms

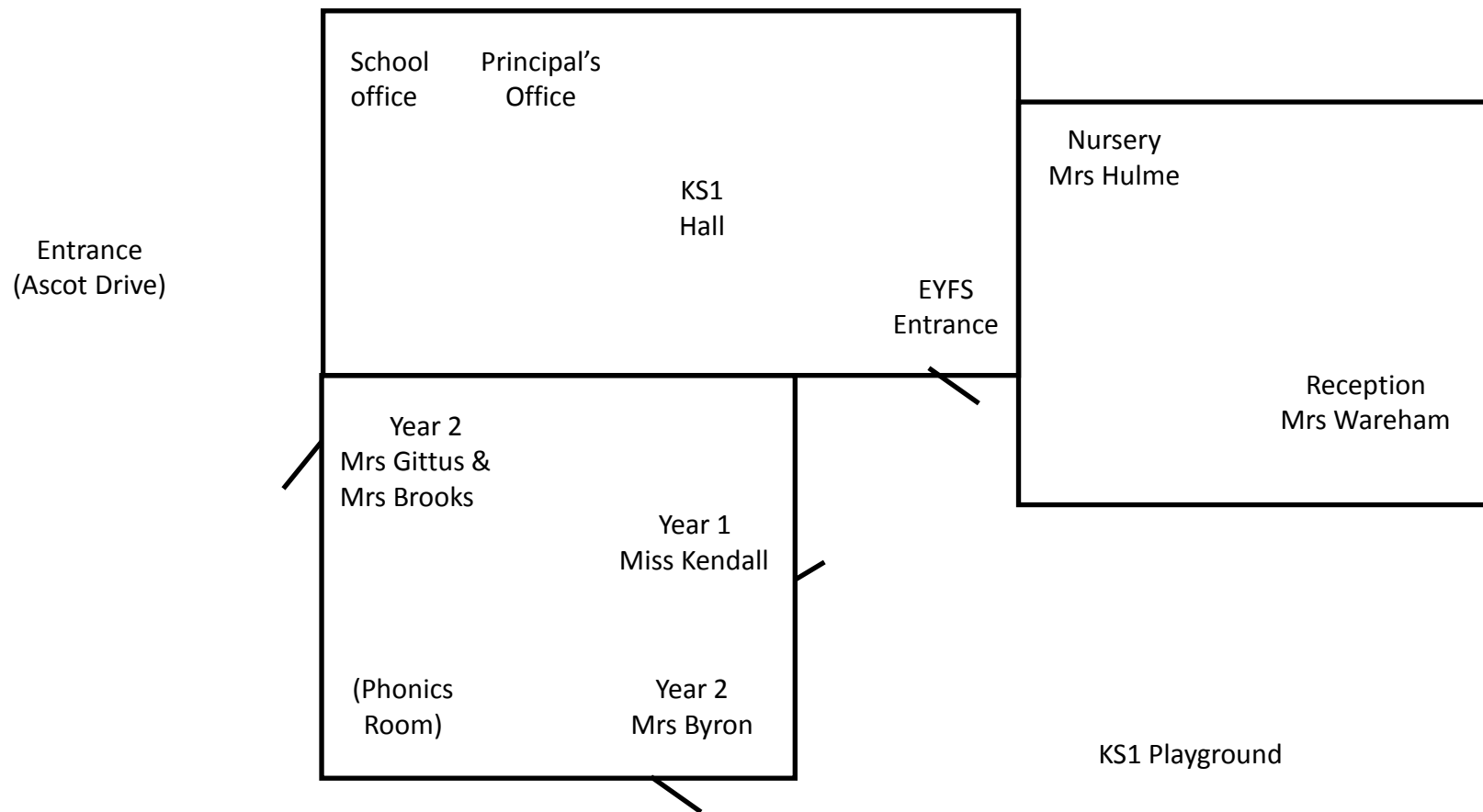

KS2 classrooms

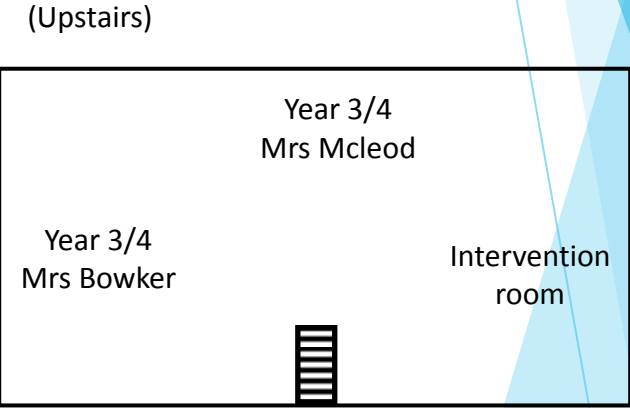
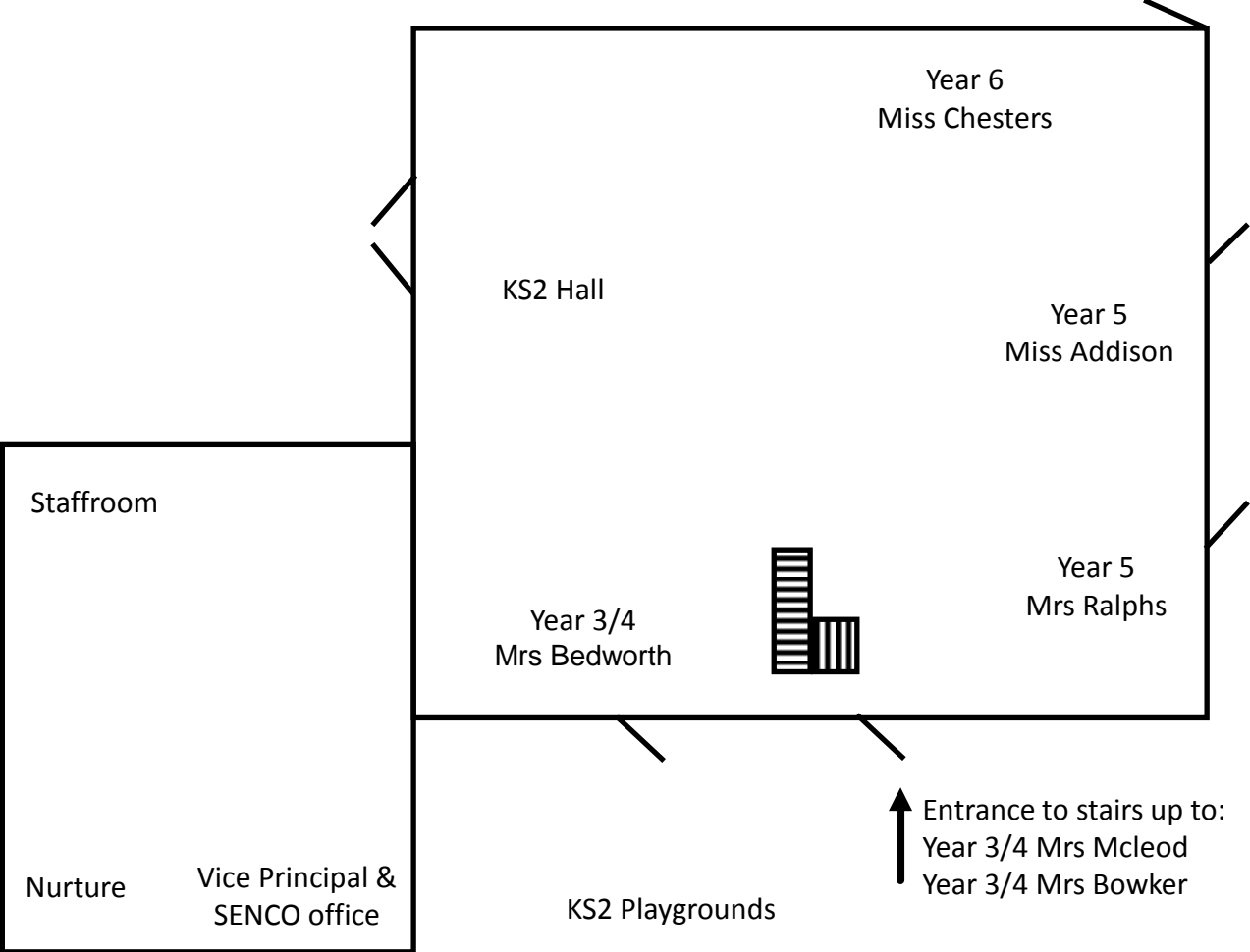

KS2 Gate
(Ascot Drive)

Transition

How we will manage transition for your child/children:

- ▶ Information pack for next academic year will be sent out:
 - ❖ Introduction to new class teacher
 - ❖ School plan showing where new classroom is
 - ❖ Topic overview for first terms learning
 - ❖ Example timetable including PE days
- ▶ Transition project (both children attending & home learning) w/b 13th July
- ▶ ‘Get to know me’ class zoom sessions with your child’s new class teacher